

# Norfolk Boreas Offshore Wind Farm

# Works Plan

## Part 4 of 4

## DCO document 2.4

Applicant: Norfolk Boreas Limited  
Document Reference: 2.4  
Deadline: 1

Date: November 2019  
Revision: Version 2  
Author: Royal HaskoningDHV

*Photo: Ormonde Offshore Wind Farm*



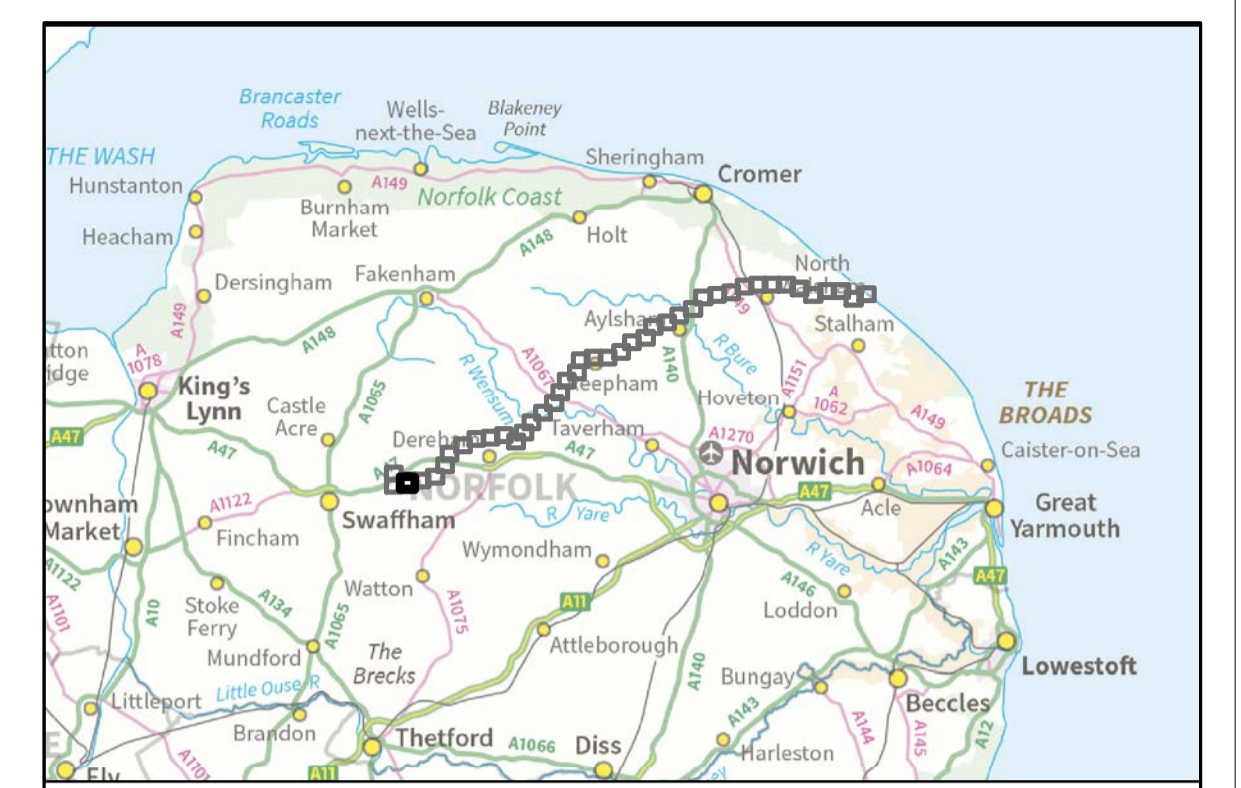
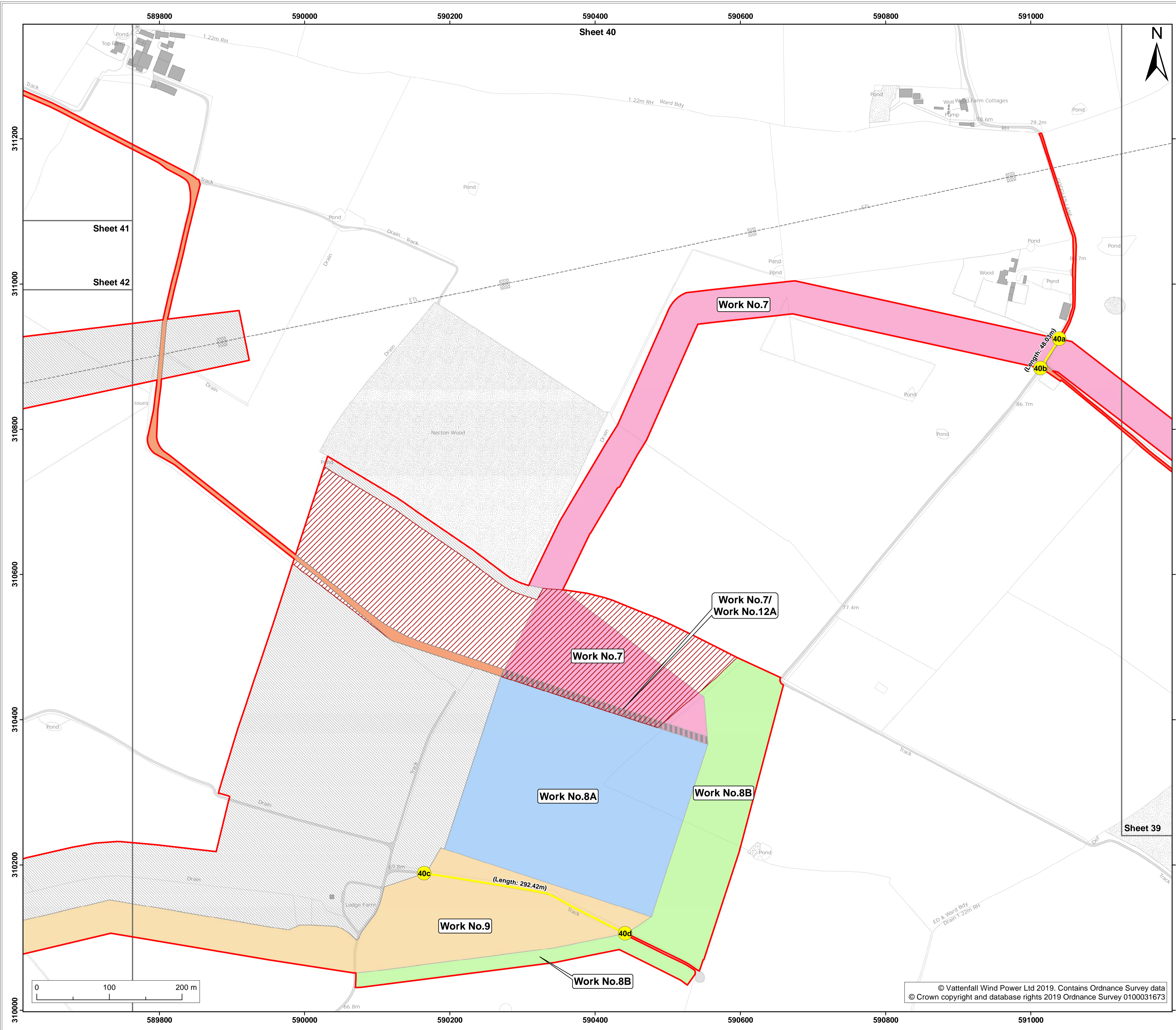

- Legend:**
- Order limits
  - Sheet boundary
  - Work No.7
  - Work No.7/Work No.12A
  - Work No.8A
  - Work No.8B
  - Work No.9
  - Alternate area only to be used under Scenario 2
- Land to be used in connection with construction or maintenance of the works**
- Temporary construction area
  - Site side access
  - Street subject to street works (private tracks)
  - Points referred to in Schedule 2 of the DCO

Project: **Norfolk Boreas Offshore Wind Farm**      Report: **Development Consent Order**

Title: **2.4 Works plan (onshore) (sheet 40a of 42 - Scenario 1)**

Doc Ref: 2.4	APFP Ref: 5(2)(j)	Drawing No: PB5640-007-000-007			
Revision: 03	Date: 19/02/2019	Drawn: LB	Checked: CD	Size: A1	Scale: 1:2,500
Revision: 02	Date: 02/01/2019	Drawn: LB	Checked: CD	Size: A1	Scale: 1:2,500

Co-ordinate system: British National Grid      EPSG: 27700



© Vattenfall Wind Power Ltd 2019. Contains Ordnance Survey data © Crown copyright and database rights 2019 Ordnance Survey 0100031673



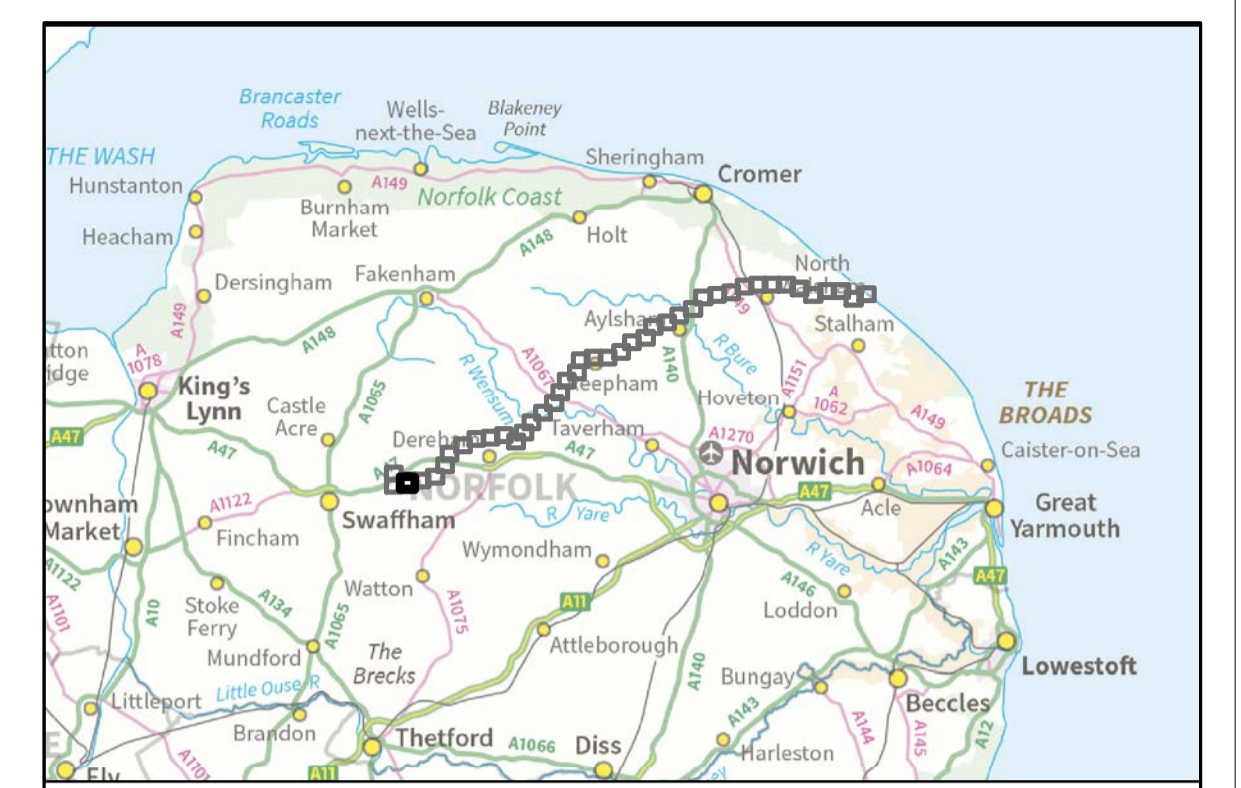
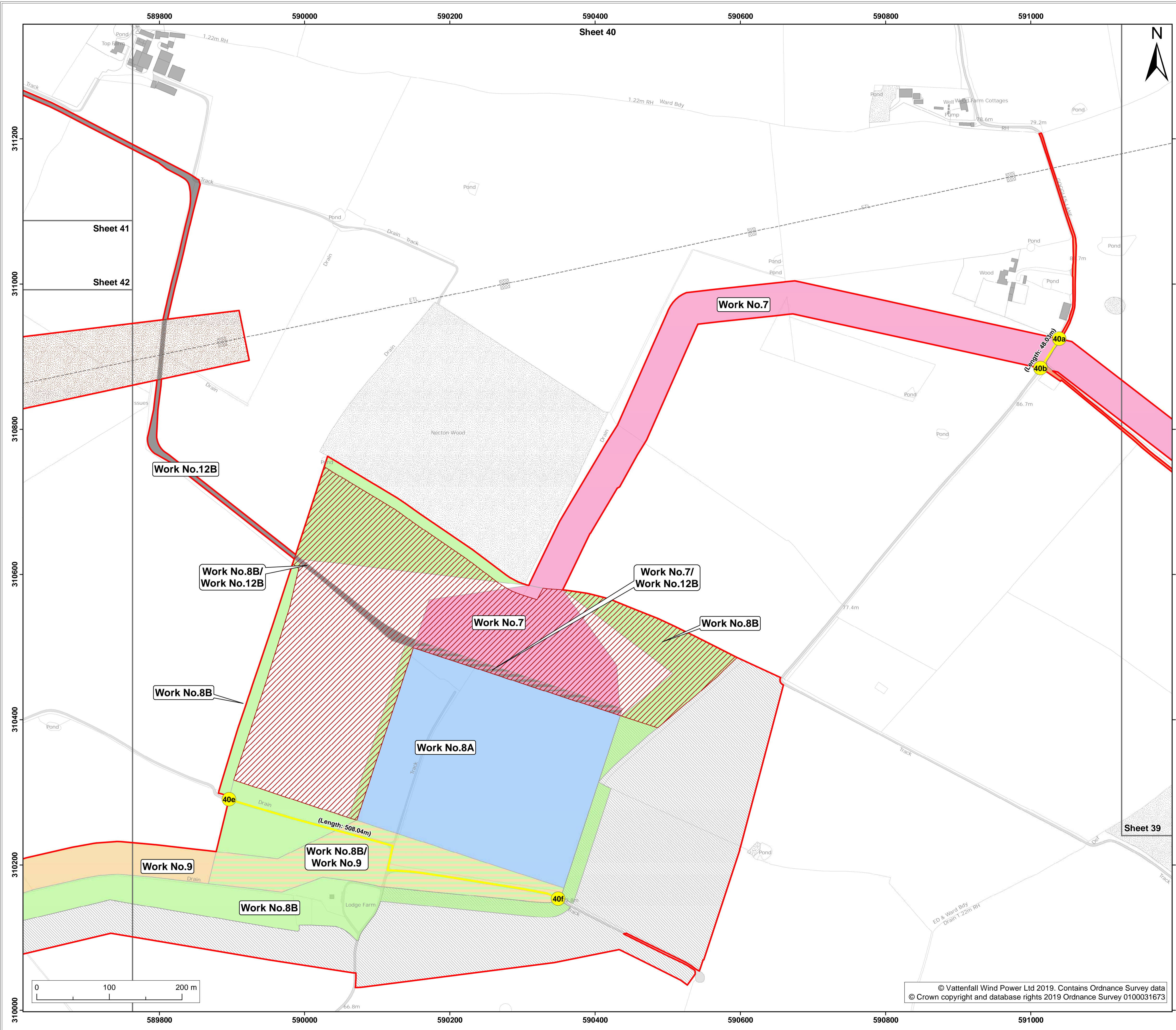

- Legend:**
- Order limits
  - Sheet boundary
  - Work No.7
  - Work No.7/Work No.12B
  - Work No.8A
  - Work No.8B
  - Work No.8B/Work No.9
  - Work No.9
  - Work No.12B
  - Alternate area only to be used under Scenario 1
- Land to be used in connection with construction or maintenance of the works**
- Temporary construction area
  - National Grid overhead line temporary works area and overhead line modification corridor
  - Site side access
  - Street subject to street works (private tracks)
  - Points referred to in Schedule 2 of the DCO

Project: **Norfolk Boreas Offshore Wind Farm**      Report: **Development Consent Order**

Title: **2.4 Works plan (onshore) (sheet 40b of 42 - Scenario 2)**

Doc Ref: 2.4	APFP Ref: 5(2)(j)	Drawing No: PB5640-007-000-008			
Revision: 04	Date: 04/03/2019	Drawn: LB	Checked: CD	Size: A1	Scale: 1:2,500
Revision: 03	Date: 19/02/2019	Drawn: LB	Checked: CD	Size: A1	Scale: 1:2,500

Co-ordinate system: British National Grid      EPSG: 27700

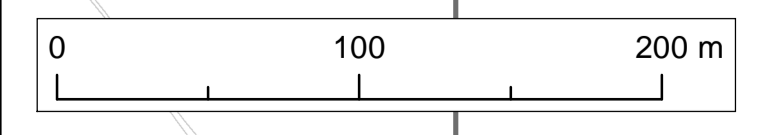

© Vattenfall Wind Power Ltd 2019. Contains Ordnance Survey data © Crown copyright and database rights 2019 Ordnance Survey 0100031673





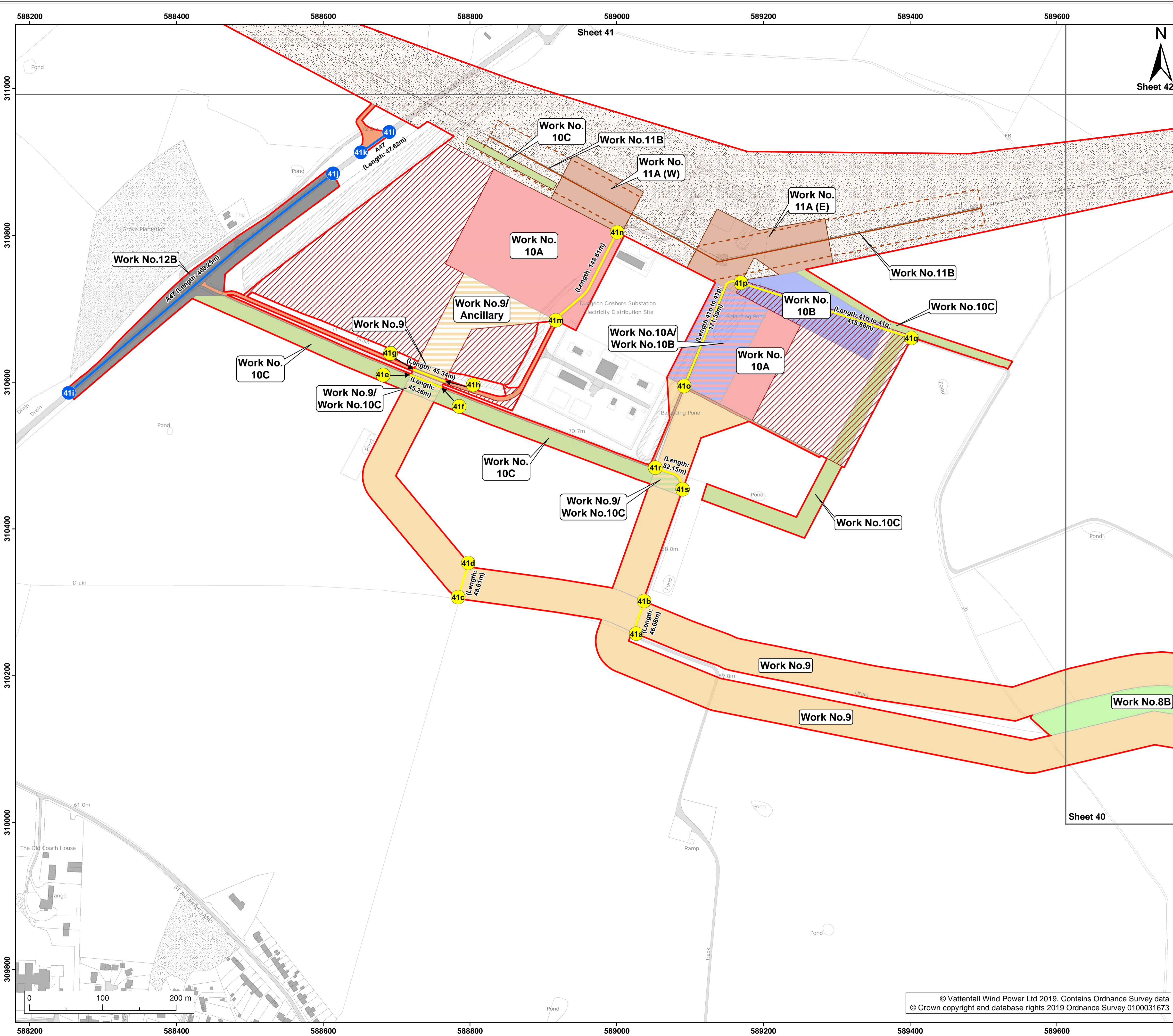

**Legend:**

- Order limits
- Sheet boundary
- Work No.8B
- Work No.9
- Work No.9/Ancillary
- Work No.9/Work No.10C
- Work No.10A
- Work No.10B
- Work No.10A/Work No.10B
- Work No.10C
- Work No.11A
- Work No.11B
- Work No.12B

**Land to be used in connection with construction or maintenance of the works**

- Temporary construction area
- National Grid overhead line temporary works area and overhead line modification corridor
- National Grid overhead line limits of deviation
- Site side access

— Street subject to street works (streets)

● Points referred to in Schedule 2 of the DCO

— Street subject to street works (private tracks)

● Points referred to in Schedule 2 of the DCO

Project: **Norfolk Boreas Offshore Wind Farm**      Report: **Development Consent Order**

Title: **2.4 Works plan (onshore) (sheet 41 of 42 - Combined plan for Scenario 1 and Scenario 2)**

Doc Ref: 2.4	APFP Ref: 5(2)(j)	Drawing No: PB5640-007-000-006			
Revision: 06	Date: 13/03/2019	Drawn: LB	Checked: CD	Size: A1	Scale: 1:2,500
Revision: 05	Date: 04/03/2019	Drawn: LB	Checked: CD	Size: A1	Scale: 1:2,500

Co-ordinate system: British National Grid      EPSG: 27700

**VATTENFALL**

**Royal HaskoningDHV**  
Enhancing Society Together

© Vattenfall Wind Power Ltd 2019. Contains Ordnance Survey data © Crown copyright and database rights 2019 Ordnance Survey 0100031673



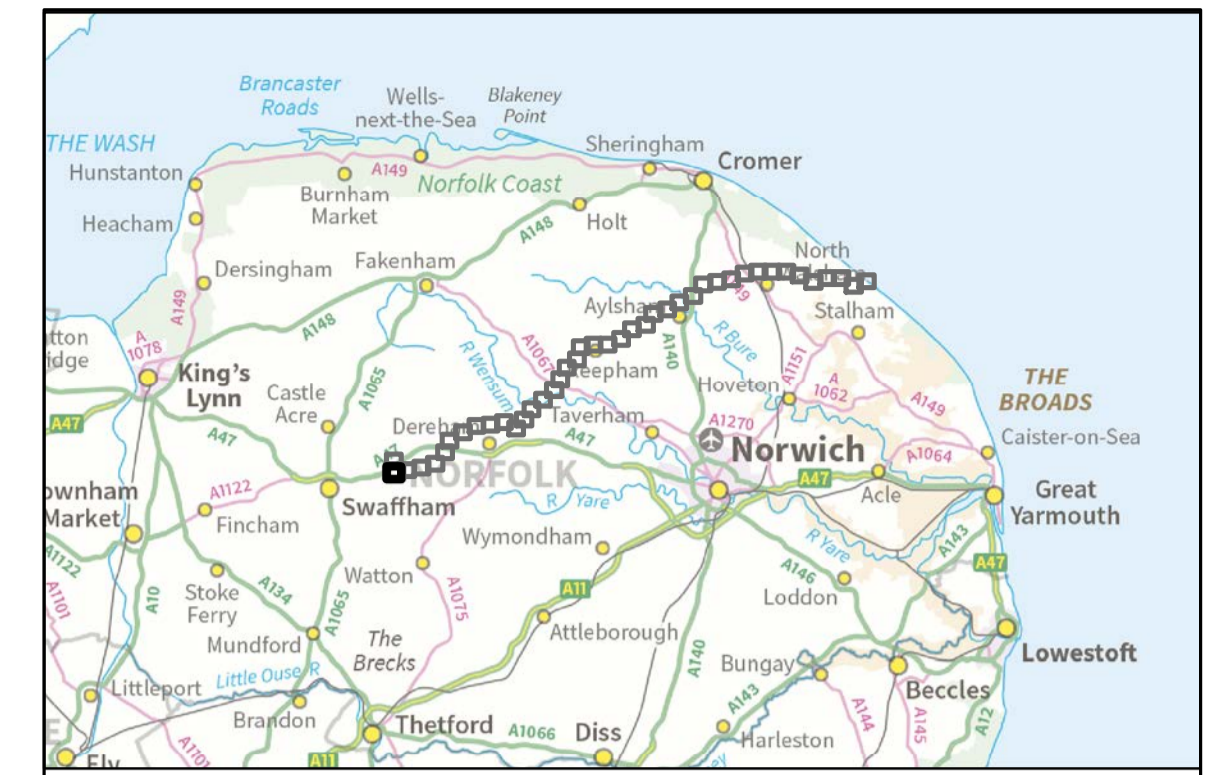
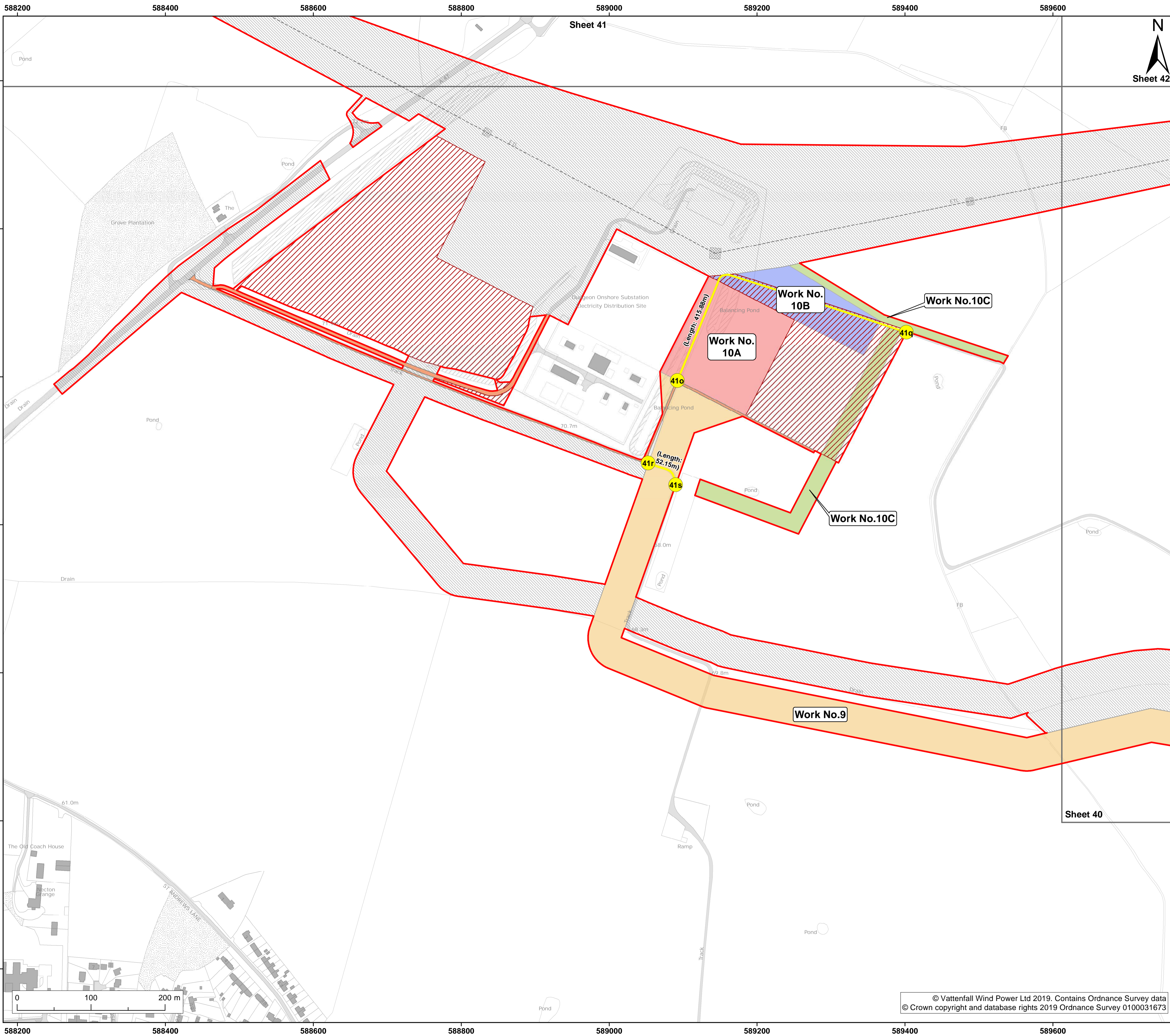

- Legend:**
- Order limits
  - Sheet boundary
  - Work No.9
  - Work No.10A
  - Work No.10B
  - Work No.10C
  - Alternate area only to be used under Scenario 2
- Land to be used in connection with construction or maintenance of the works**
- Temporary construction area
  - Site side access
  - Street subject to street works (private tracks)
  - Points referred to in Schedule 2 of the DCO

Project: **Norfolk Boreas Offshore Wind Farm**      Report: **Development Consent Order**

Title: **2.4 Works plan (onshore) (sheet 41a of 42 - Scenario 1)**

Doc Ref: 2.4	APFP Ref: 5(2)(j)	Drawing No: PB5640-007-000-006			
Revision: 05	Date: 29/04/2019	Drawn: LB	Checked: CD	Size: A1	Scale: 1:2,500
Revision: 04	Date: 19/02/2019	Drawn: LB	Checked: CD	Size: A1	Scale: 1:2,500

Co-ordinate system: British National Grid      EPSG: 27700



© Vattenfall Wind Power Ltd 2019. Contains Ordnance Survey data  
© Crown copyright and database rights 2019 Ordnance Survey 0100031673



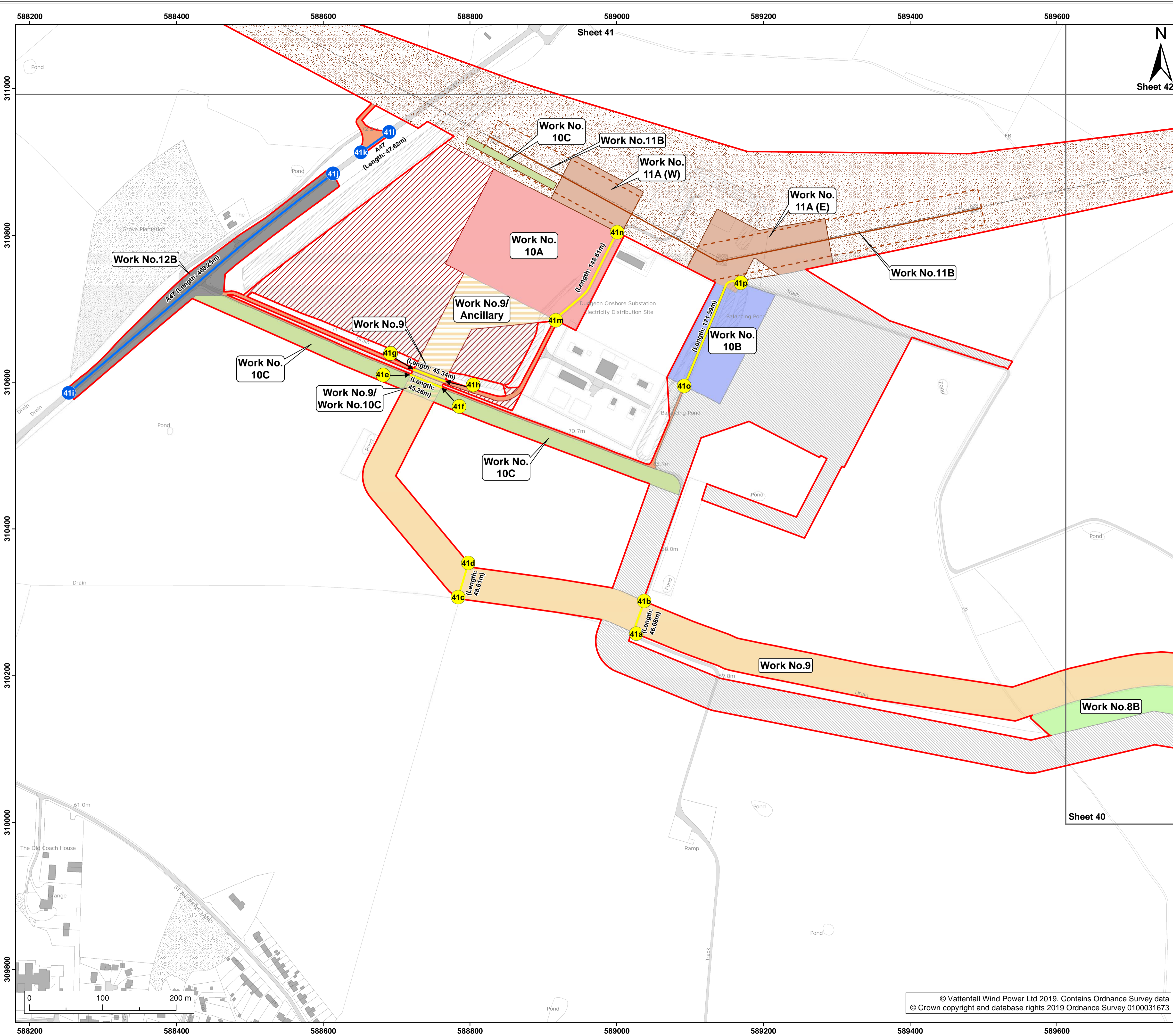

**Legend:**

- Order limits
- Sheet boundary
- Work No.8B
- Work No.9
- Work No.9/Ancillary
- Work No.9/Work No.10C
- Work No.10A
- Work No.10B
- Work No.10C
- Work No.11A
- Work No.11B
- Work No.12B
- Alternate area only to be used under Scenario 1

**Land to be used in connection with construction or maintenance of the works**

- Temporary construction area
- National Grid overhead line temporary works area and overhead line modification corridor
- National Grid overhead line limits of deviation
- Site side access

- Street subject to street works (streets)
- Points referred to in Schedule 2 of the DCO
- Street subject to street works (private tracks)
- Points referred to in Schedule 2 of the DCO

Project: **Norfolk Boreas Offshore Wind Farm**      Report: **Development Consent Order**

Title: **2.4 Works plan (onshore) (sheet 41b of 42 - Scenario 2)**

Doc Ref: 2.4	APFP Ref: 5(2)(j)	Drawing No: PB5640-007-000-010			
Revision: 05	Date: 12/03/2019	Drawn: LB	Checked: CD	Size: A1	Scale: 1:2,500
Revision: 04	Date: 04/03/2019	Drawn: LB	Checked: CD	Size: A1	Scale: 1:2,500

Co-ordinate system: British National Grid      EPSG: 27700



**VATTENFALL**



**Royal HaskoningDHV**  
Enhancing Society Together







588200 588400 588600 588800 589000 589200 589400 589600

Sheet 42

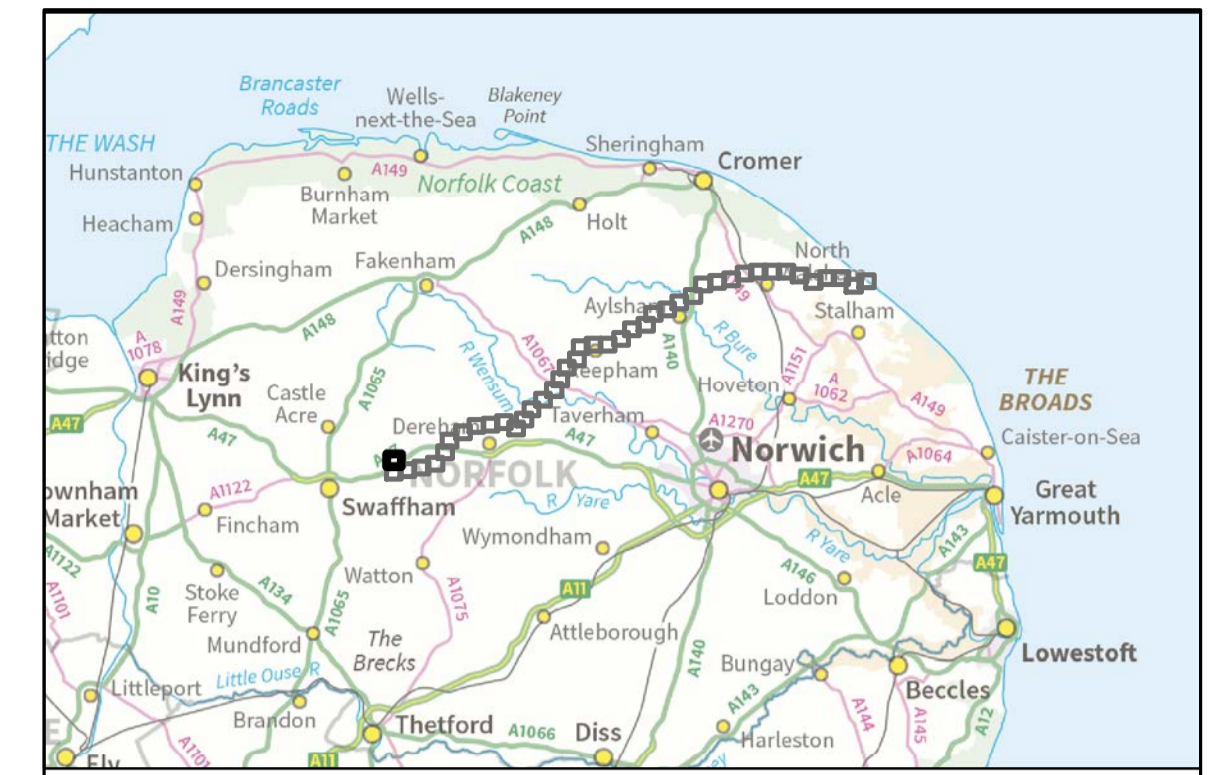
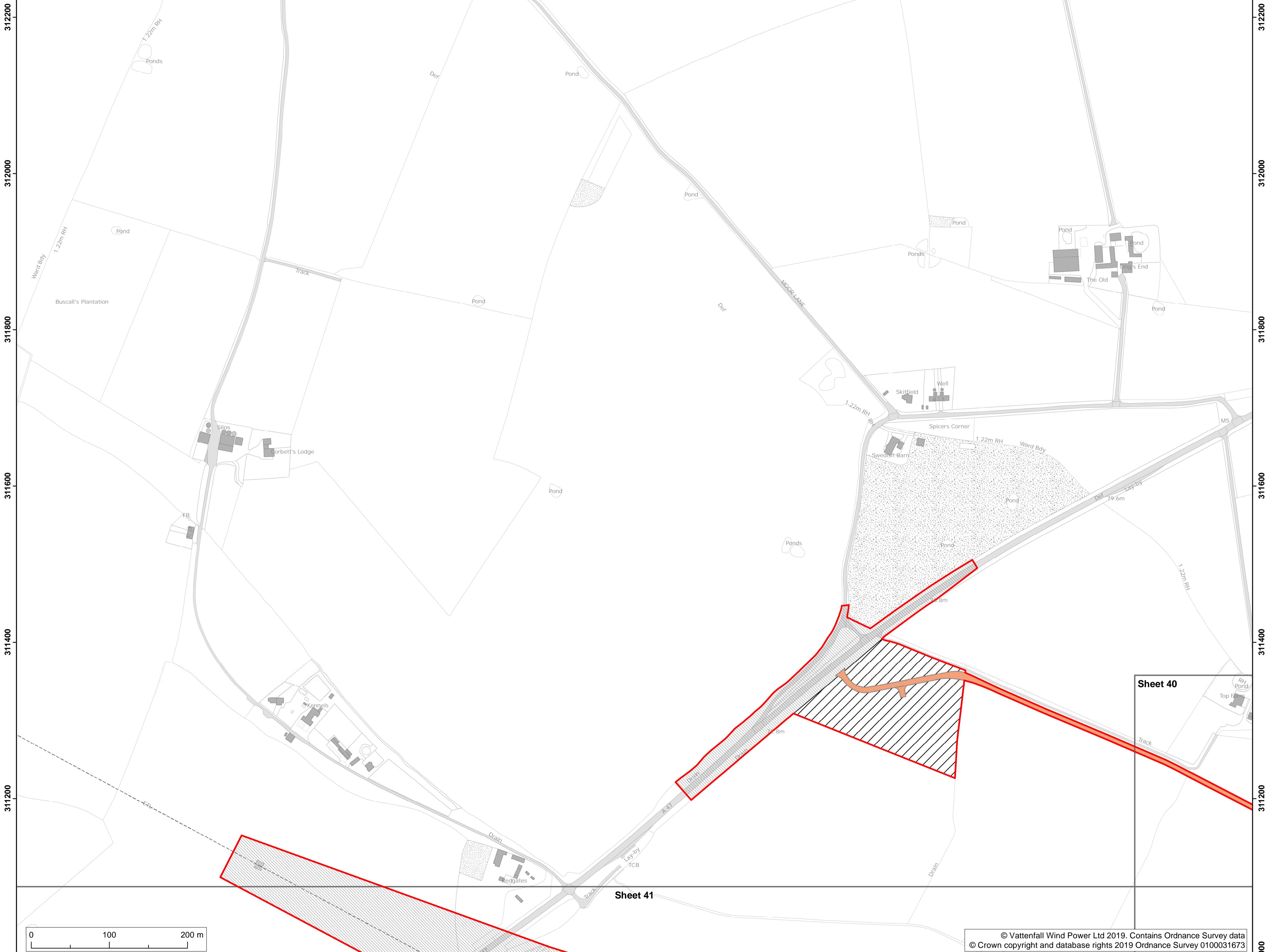

- Legend:**
- Order limits
  - Sheet boundary
  - Alternate area only to be used under Scenario 2
  - Land to be used in connection with construction or maintenance of the works**
    - Mobilisation zone
    - Site side access

Project: **Norfolk Boreas Offshore Wind Farm** Report: **Development Consent Order**

Title: **2.4 Works plan (onshore) (sheet 42a of 42 - Scenario 1)**

Doc Ref: 2.4	APFP Ref: 5(2)(j)	Drawing No: PB5640-007-000-006			
Revision: 03	Date: 19/20/2019	Drawn: LB	Checked: CD	Size: A1	Scale: 1:2,500
02	02/01/2019	LB	CD	A1	1:2,500

Co-ordinate system: British National Grid EPSG: 27700

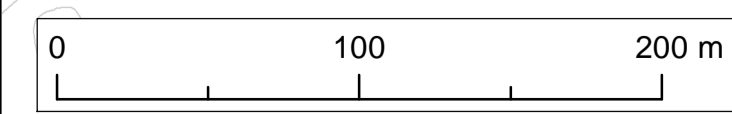

© Vattenfall Wind Power Ltd 2019. Contains Ordnance Survey data © Crown copyright and database rights 2019 Ordnance Survey 0100031673



588200 588400 588600 588800 589000 589200 589400 589600

311000

Sheet 41

Sheet 40

311200 311800 311600 311400 311200



588200 588400 588600 588800 589000 589200 589400 589600

Sheet 42

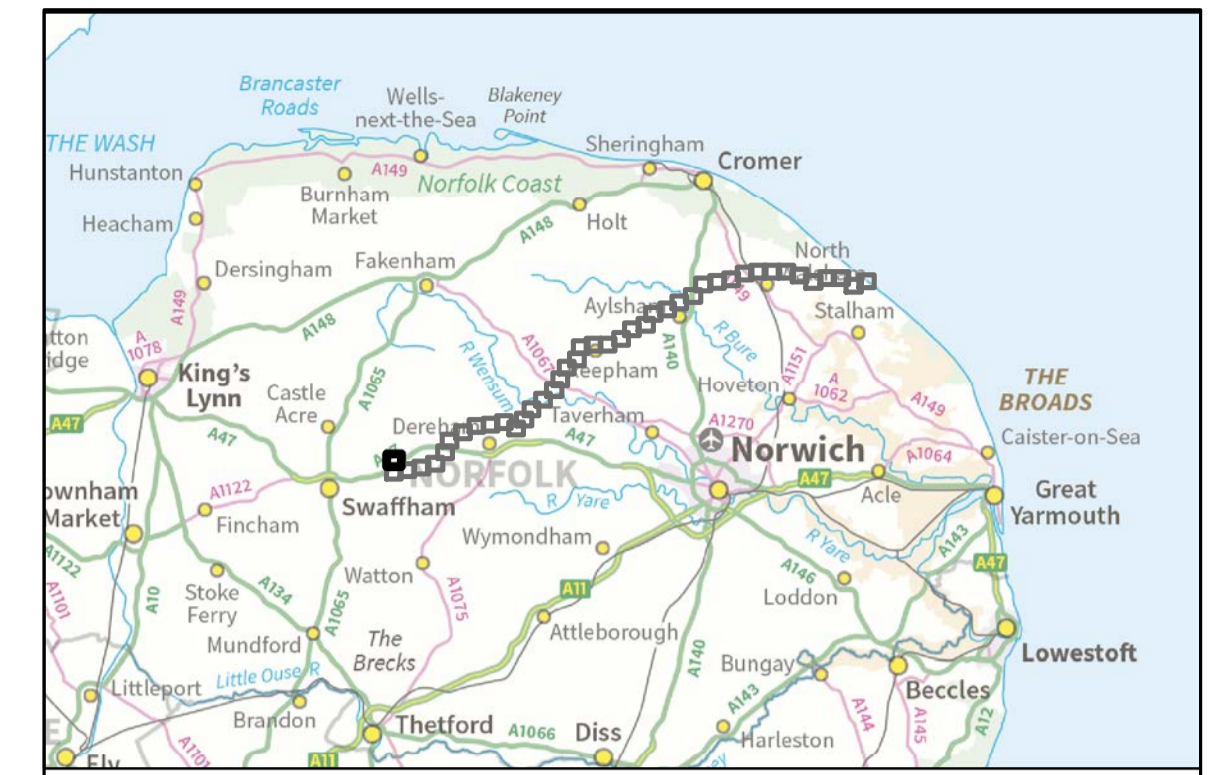
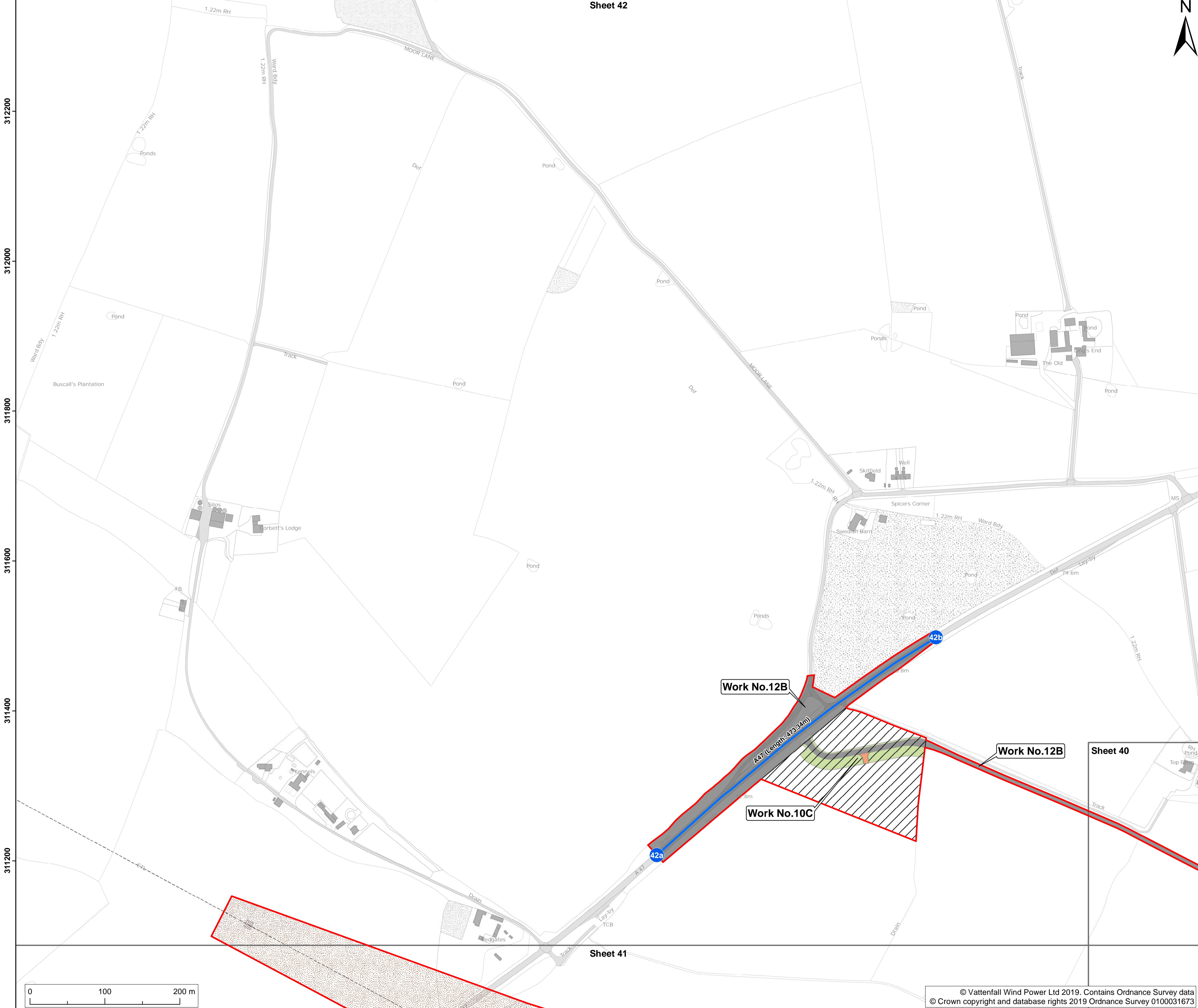

**Legend:**

- Order limits
- Sheet boundary
- Work No.10C
- Work No.12B
- Land to be used in connection with construction or maintenance of the works**
- Mobilisation zone
- National Grid overhead line temporary works area and overhead line modification corridor
- Site side access
- Street subject to street works (streets)
- Points referred to in Schedule 2 of the DCO

Project: **Norfolk Boreas Offshore Wind Farm** Report: **Development Consent Order**

Title: **2.4 Works plan (onshore) (sheet 42b of 42 - Scenario 2)**

Doc Ref: 2.4	APFP Ref: 5(2)(j)	Drawing No: PB5640-007-000-010			
Revision: 03	Date: 19/02/2019	Drawn: LB	Checked: CD	Size: A1	Scale: 1:2,500
Revision: 02	Date: 02/01/2019	Drawn: LB	Checked: CD	Size: A1	Scale: 1:2,500

Co-ordinate system: British National Grid EPSG: 27700

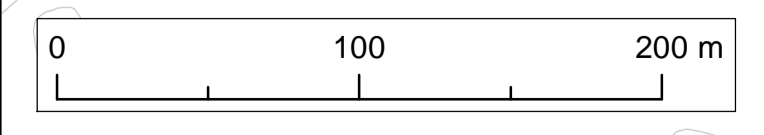

© Vattenfall Wind Power Ltd 2019. Contains Ordnance Survey data © Crown copyright and database rights 2019 Ordnance Survey 0100031673



588200 588400 588600 588800 589000 589200 589400 589600

311000